

Conexão Miniatura Metálica para Tubo Ø2,3,2,4 e 6mm, Rosca M3,M5 e 1/8"- Série F

Conexão Retra Espigão tubo Ø2: F-3AU-2, F-5AU-2



Applicable tubing O.D. / I.D. (mm)	Connection thread	Model	H	A	B	C	D	E	F	Weight (g)
ø2 / ø1.2	M3 x 0.5	F-3AU-2	4.5	9	3	4	5	4	0.9	0.7
	M5 x 0.8	F-5AU-2	7	10	4					7.7

Component Parts

No.	Description	Material	Note
1	Sleeve	C3604	Electroless nickel plated
2	Barb fitting	C3604	Electroless nickel plated
3	Gasket	NBR, Stainless steel 304	—

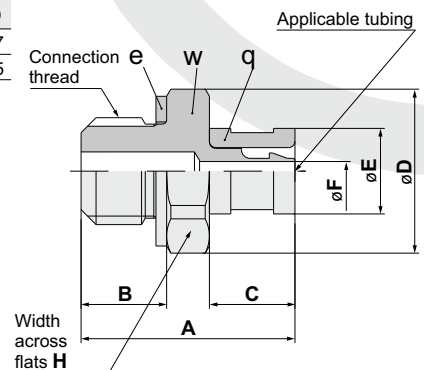

Conexão Cotovelo Espigão tubo Ø2: F-3ALU-2, F-5ALHU-2



Applicable tubing O.D. / I.D. (mm)	Connection thread	Model	H	A	B	C	D	E	F	G	I	J	Weight (g)
ø2 / ø1.2	M3 x 0.5	F-3ALU-2	5	9	6.5	4	4	0.9	2.5	2.5	9.4	5	1.6
	M5 x 0.8	F-5ALHU-2	7	11	7.5								

Component Parts

No.	Description	Material	Note
1	Sleeve	C3604	Electroless nickel plated
2	Stud	C3604	Electroless nickel plated
3	Barb elbow	C3604	Electroless nickel plated
4	Gasket	NBR, Stainless steel 304	—

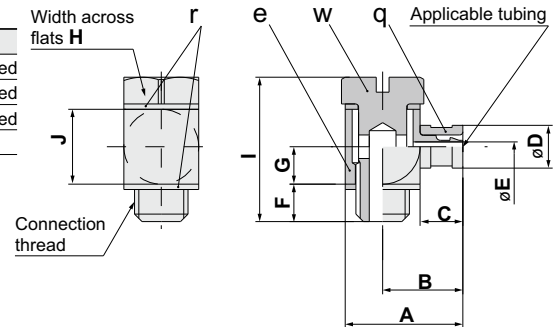

Conexão Retra de Redução: F-32F-2, F-04F-2



Applicable tubing (mm)		Model	A	B	C	D	E	M	Weight (g)
Ⓐ (O.D. / I.D.)	Ⓑ (O.D.)								
ø2 / ø1.2	ø3.2	F-32F-2	17.7	13.7	7.5	4	0.9	12.7	2.4
	ø4	F-04F-2	18	14	8.5				2.9

Component Parts

No.	Description	Material	Note
1	Sleeve	C3604	Electroless nickel plated
2	Body	C3604	Electroless nickel plated
3	Seal	NBR	—
4	Cassette	POM, Stainless steel 304	—

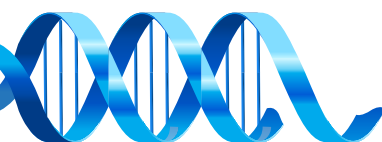
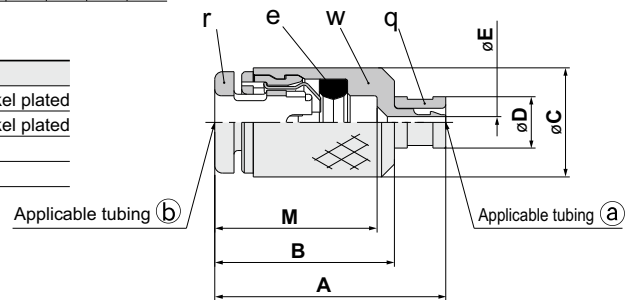

Rosca M3

Conexão Reta Espigão tubo Ø3: F-3AU-3

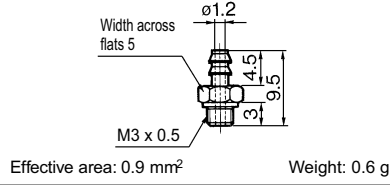

Conexão Reta Espigão tubo Ø4: F-3AU-4

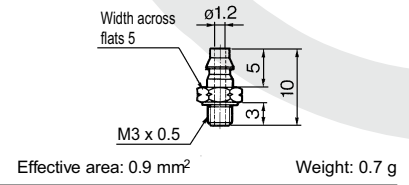

Conexão Cotovelo Espigão tubo Ø3: F-3ALU-3

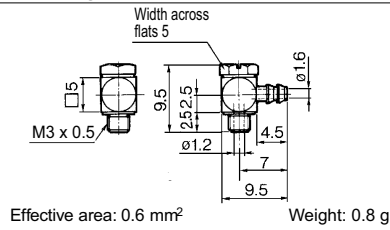

Conexão Cotovelo Espigão tubo Ø4: F-3ALU-4

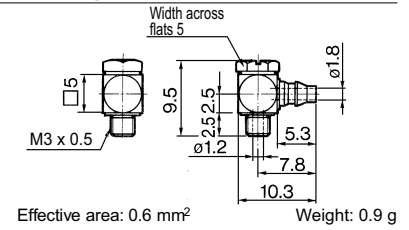

Cotovelo Macho Fêmea Rosca M3: F-3UL

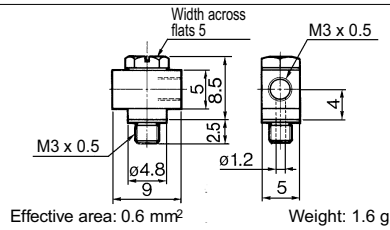

'T' Rosca M3: F-3UT

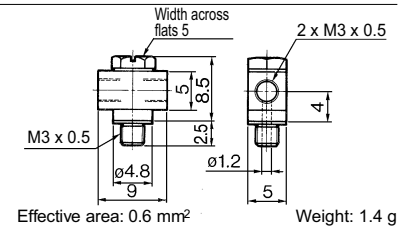

Niple Rosca M3: F-3N

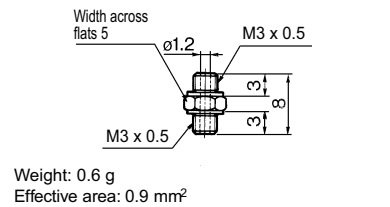

Tampão rosca M3: F-3P

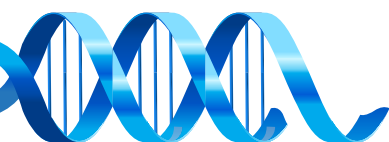
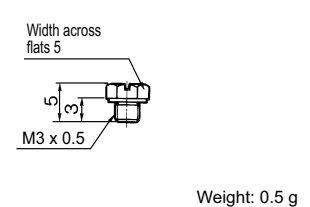

Conexão Miniatura Metálica para Tubo Ø2,3,2,4 e 6mm, Rosca M3,M5 e 1/8"- Série F

Rosca M5

Conexão Retra Espigão tubo Nylon: F-5AN-4/-6



Model	A	B	øC	Effective area (mm ²)	Weight (g)
F-5AN-4	12	5	1.8	2.1	1.6
F-5AN-6	14	8	2.5	4.0	1.7

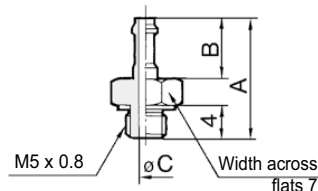

Conexão Retra Espigão tubo PU: F-5AU-3/-4/-6



Model	A	B	øC	Effective area (mm ²)	Weight (g)
F-5AU-3	11.5	4.5	1.6	1.7	1.5
F-5AU-4	12	5	1.8	2.1	1.6
F-5AU-6	14	7	2.5	4.0	1.8

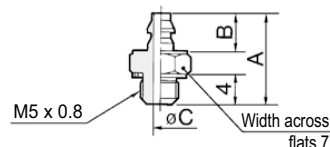

Conexão Cotovelo Curto Espigão tubo Nylon: F-5ALN-4/-6

Conexão Cotovelo Curto Espigão tubo PU: F-5ALU-3/-4/-6



Modelo	A	B	C	øD	Effective area (mm ²)	Weight (g)
F-5ALN-4	13	9	5	1.8	1.4	4.0
F-5ALN-6	15	11	7	2.5	2.4	4.4
F-5ALU-3	13	9	4.5	1.6	1.1	4.0
F-5ALU-4	13.5	9.5	5	1.8	1.4	4.1
F-5ALU-6	15.5	11.5	7	2.5	2.4	4.5

**F-5ALN-4
F-5ALU-3/-4**

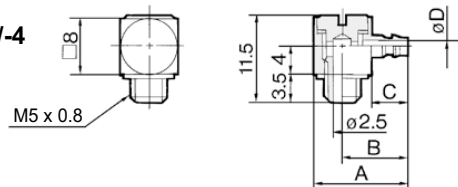

**F-5ALN-6
F-5ALU-6**

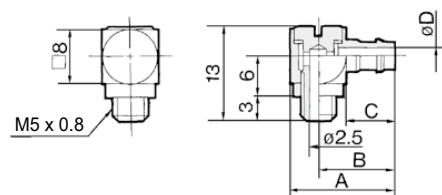

Conexão de Compressão rosca M5 tubo Ø4,6: Hose F-5H-



Model	A	B	C	øD	øE	H	Effective area (mm ²)	Weight (g)
F-5H-4	15.5	8.5	7	1.8	6.5	7	2.1	2.7
F-5H-6	16.5	9.5	8	2.5	8.5	8	4.0	3.9

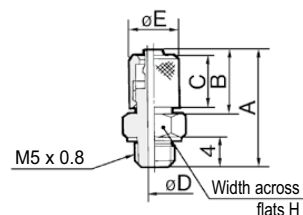

Conexão Cotovelo Curto de Compressão, rosca M5 tubo Ø4,6: F-5HL-



Model	A	B	C	D	øE	øF	Effective area (mm ²)	Weight (g)
F-5HL-4	16.5	12.5	8.5	7	1.8	6.5	1.4	4.4
F-5HL-6	17.5	13.5	9.5	8	2.5	8.5	2.4	5.2

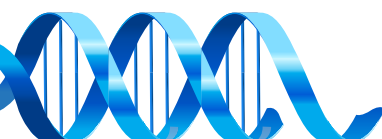
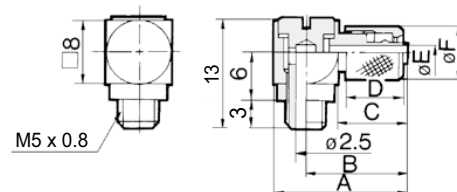

Conexão Miniatura Metálica para Tubo Ø2,3,2,4 e 6mm, Rosca M3,M5 e 1/8"- Série F

Rosca M5

Cotovelo Fêmea Rosca M5: F-5L

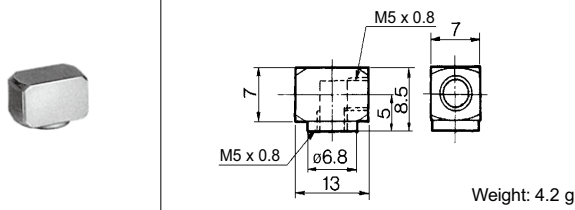

'T' Fêmea Rosca M5: F-5T

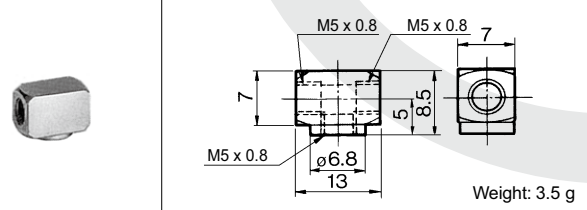

Cotovelo Macho Fêmea Rosca M5: F-5UL

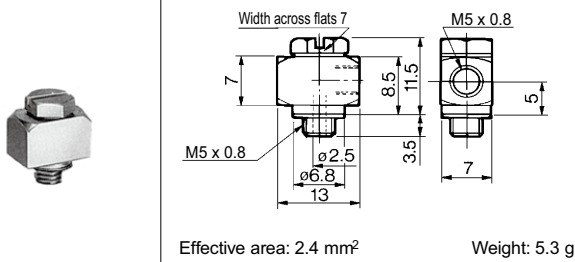

'T' Macho Fêmea Rosca M5: F-5UT

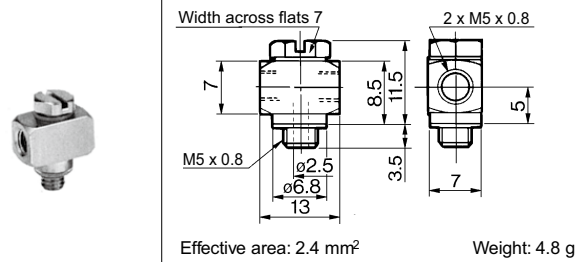

Extensor de R. Macho Fêmea Rosca M5: F-5J

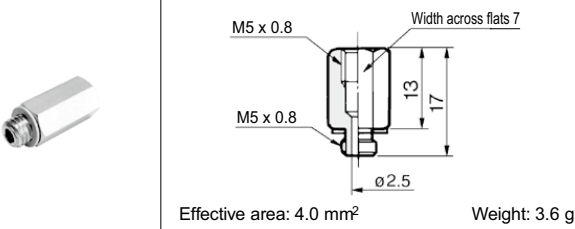

Nilpe Rosca M5: F-5N

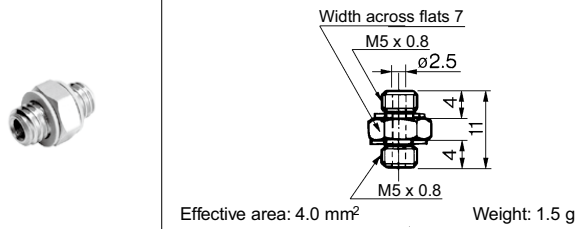

Niple Universal Rosca M5: F-5UN

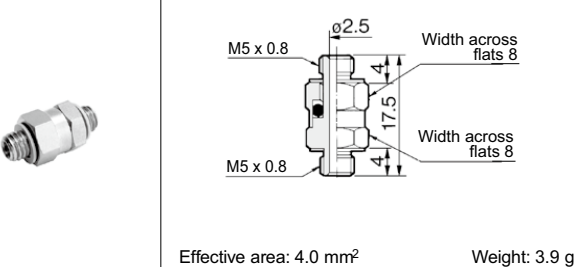

Passa Muro Rosca Fêmea M5: F-5E

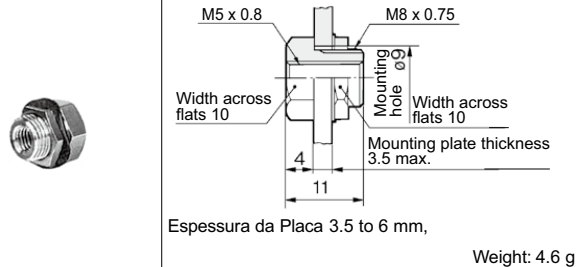

Rosca de 1/8

Conexão de Espigão, para tubo de Nylon e PU rosca 1/8" tubo Ø4,6: F-01AN-

Tubo Aplicável	Modelo	A	B	øC	Effective area (mm²)	Weight (g)
Tubo de Nylon	F-01AN-4	15.1	5	1.8	2.1	6.4
	F-01AN-6	17.1	7	2.5	4.0	6.6
PU	F-01AU-4	15.1	5	1.8	2.1	6.5
	F-01AU-6	17.1	7	2.5	4.0	6.7

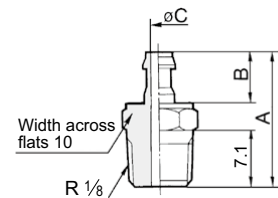

Conexão de Compressão, rosca 1/8" tubo Ø4,6: F-01H-

Model	A	B	øC	øD	E	Effective area (mm²)	Weight (g)
F-01H-4	18.6	8.5	1.8	6.5	7	2.1	7.1
F-01H-6	19.6	9.5	3	8.5	8	5.5	7.7

